



THE STRONGEST SCREED FOR THE MOST DEMANDING SITUATIONS

Anhydritec Ltd has developed the **Gyvlon® XTR® FDE2C® technology** to address commercial and domestic buildings where floors are subjected to higher loadings than usual.

Gyvlon® XTR® FDE2C® technology is the ideal solution for buildings with increased loading like: high foot traffic areas, car showrooms, commercial applications, hospitals and also Lewis steel decking.

With the addition of Faster Drying (**FD**) and Early to Cover (**E2C®**) technologies, the installation of floor covering is achieved twice as fast as standard screeds^F; allowing tiles^D and vinyls^E to be laid safely from 1.5% MC, speeding up installations.

A UNIQUE SOLUTION TO ACHIEVE HIGH STRENGTH WITH NO COMPROMISE

Gyvlon® XTR® FDE2C® technology is a cost-effective and flexible liquid flowing screed which exhibits high mechanical performance (C35-F7) while still maintaining its natural high stability, large bay sizes, quick install methods and is ideal to receive most floor coverings.

ALL THE BENEFITS OF GYVLON® SCREED PRODUCTS

XTR® FDE2C® technology has all the benefits that you have come to expect from a Gyvlon® screed product based over 30 years' experience:

- **Very high fluidity** for fast installation
- **No shrinkage** greatly reduced cracking, no curling
- **Large bay sizes** up to 800 m²
- **No reinforcement**
- **No curing membrane**
- **Minimum SR2 surface finish**
- **Environmentally friendly, greatly reduced CO₂ and carbon content**



MAIN FEATURES

- ➔ **Outstanding mechanical strength (C35-F7)**
- ➔ **Ideal solution for high load floors**
- ➔ **Fast drying (FD)**
- ➔ **Early to cover (E2C®)**
Twice as fast to cover^F from 1.5% moisture content for tiles^D and vinyls^E

EPD® LOW CARBON SOLUTION <90% REDUCTION

- EXCELIO® TECHNOLOGY** *The ultra-thin readymix flowing subbase leveller*
- FINIO® TECHNOLOGY** *The thin and lightweight flowing screed solution*
- THERMIO® MAX TECHNOLOGY** *The guaranteed ultra-efficient screed for underfloor heating*
- XTR® FD/E2C TECHNOLOGY** *The strongest screed for the most demanding situations*
- ECO FD/E2C TECHNOLOGY** *The Gyvlon® screed version with faster drying (FD) and early to cover (E2C®)*
- ECO TECHNOLOGY** *Anhydritec's versatile Gyvlon® screed*

THE STRONGEST SCREED FOR THE MOST DEMANDING SITUATIONS



➤ HIGH STRENGTH AND LOW THICKNESS

Gyvlon® XTR® FD E2C® combines high mechanical performance (C35-F7) with a low section (30 mm unbonded) which allows its utilisation in buildings where increased loads are required without unnecessary increasing in floor build-ups.



➤ HIGH LOAD FLOATING FLOOR

Gyvlon® XTR® FD E2C® is ideal on floating screed floors subjected to both high dead and temporary loadings such as those encountered in retail units, supermarkets or high foot traffic areas.



(The performance of the system is also dependent on the loading characteristics of the insulation).

➤ LEWIS DECK

Gyvlon® XTR® FD E2C® screed is suitable for the Lewis deck dovetail sheeting; for use with timber; metal web or steel joists in masonry and timber or light weight steel structures. Lewis deck and **Gyvlon® XTR® FD E2C®** create a thin lightweight system (from only 36 mm) with an excellent fire rating (up to 120 minutes) and is used to form suspended floor systems.

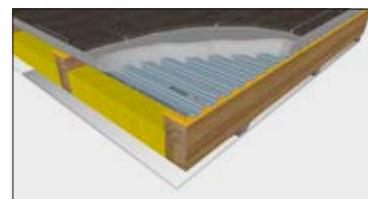

OUTSTANDING PERFORMANCE

TECHNICAL CHARACTERISTICS	
Mechanical strength	C35 / F7 - BSEN13813
Dry density	2000 kg/m ³ (± 200)
Design minimal thickness	30 mm - unbonded 35 mm (domestic) - floating 40 mm (commercial) - floating
Substrate type	Suitable for most substrates
Substrate regularity	SR2 – BSEN 8204-7

INSTALLATION BENEFITS	
Flow	240 mm (± 10 mm)
Max Bay Size	800 m ²
Productivity	Up to 200 m ² / hour

MAX MOISTURE CONTENT OF SUBSTRATE ^{A,B}		
Carpets from 2% MC ^C	Tiles from 1.5% MC ^D	Vinyls from 1.5% MC ^E

The technologies FD and E2C® are patented by ANHYDRITEC®

- A. Carbide measurement or ove, drying at 40°C. Adhesive manufacturers recommendation should also be followed
- B. UFH screed values: Tiles 1%, Vinyls 1% & Carpets 2%. Before applying a floor covering, the UFH must be commissioned in accordance with industry guidelines
- C. Bonded carpet excluded
- D. A suitable primer should be used as per industry recommendation
- E. With suitable vapour barrier & smoothing compound; if direct bond where finishes allow then 1%
- F. Typically floor covering can be installed twice as soon as other generic calcium sulphate screeds regardless of thickness and dry conditions.

FD TECHNOLOGY **FASTER DRYING**

Significantly speed up the drying process

E2C TECHNOLOGY **EARLY TO COVER**

Covering is allowed from 1.5% moisture content for tiles² and vinyls³



www.gyvlon.co.uk www.anhydritec.com

ANHYDRITEC LTD - Unit 221, Europa Boulevard, Westbrook, Warrington, WA5 7TN - T. 01925 428 780 - anhydritec.enquiries.uk@minersa.com